

Connection Guide dLive / SQ Church Installation

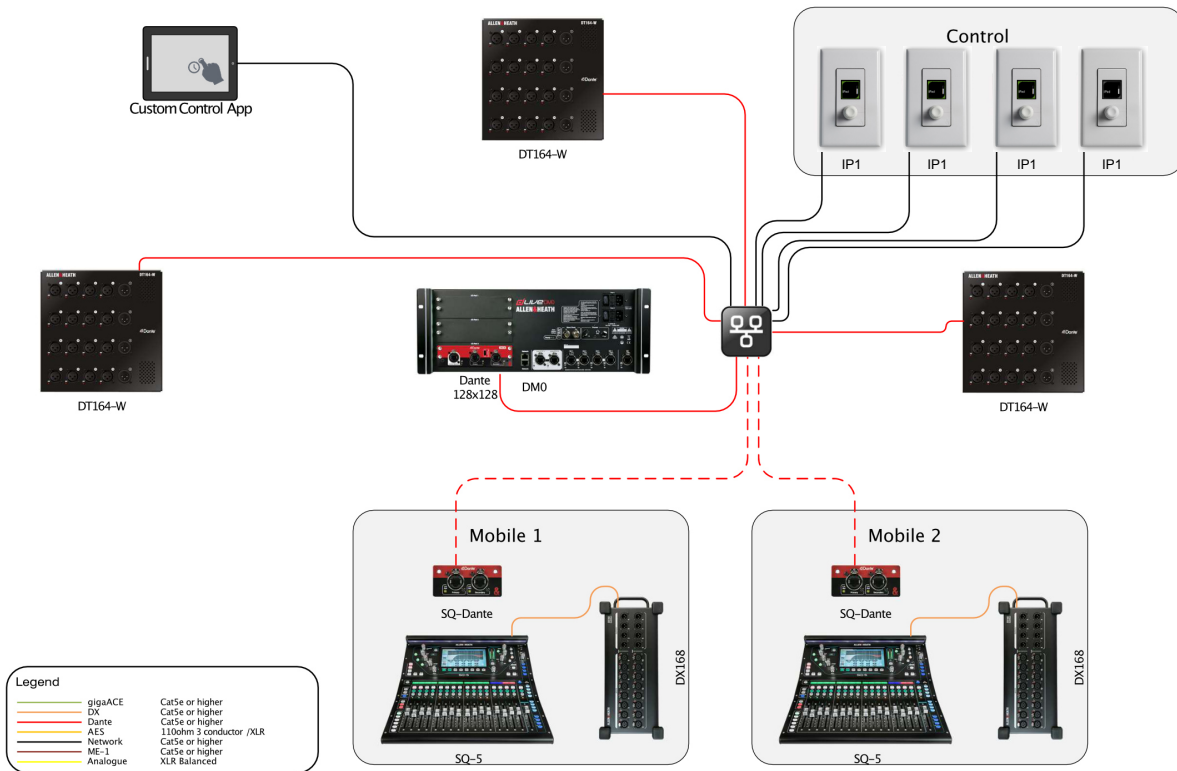

Please note that items may not be sized to scale.

Parts List

- Two - dLive DM0
- Two - AH-M-DL-DANTE128A
- Three - DT164-W wall expanders
- Four - IP1 controller
- Two - SQ-5
- Two - AH-M-SQ-SDANTE-A Dante Cards
- Two - DX168 expander boxes
- One - Dante approved network switch
- One - Wi-Fi router
- One - Tablet or mobile device with free Custom Control App

Notes

- dLive is capable of mixing up to 128 inputs.
- SQ is capable of mixing up to 48 inputs.
- Shielded Cat5e or better is recommended.
- Mobile 1 or 2 could be monitor consoles, broadcast booth, recording truck or overflow room.

If you have any questions please contact your local rep.
Find more drawings at www.ProTechM.com/tools